

## INSTRUCTIONS FOR USE

# AbbVie Belt Pouch for VYAFUSER

*For use with Vyafuser™ Pump*

This guide pertains only to the use of the AbbVie Belt Pouch for VYAFUSER. For questions or problems, refer to these Instructions for Use or call support toll free at 1-866-489-2538.

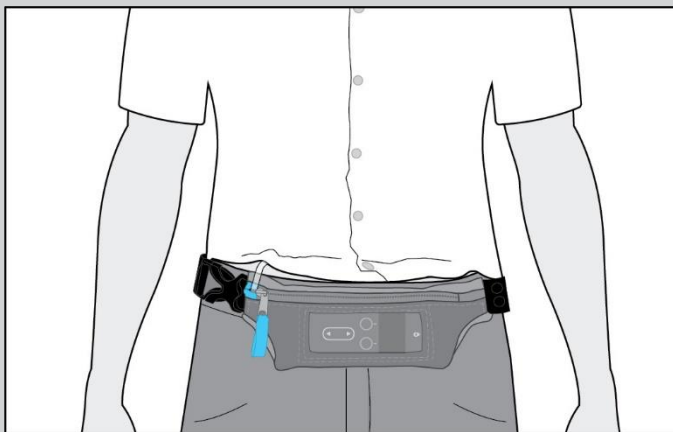

### **About your Belt Pouch for VYAFUSER:**

The AbbVie Belt Pouch carrying accessory is qualified to carry a VYAFUSER Pump. The AbbVie Belt Pouch for VYAFUSER carrying accessory is intended for single-patient use only. The AbbVie Belt Pouch for VYAFUSER carrying accessory is indicated for use by patients with advanced Parkinson's disease.

The AbbVie Belt Pouch is intended to be worn around the waist. The AbbVie Belt Pouch for VYAFUSER is packaged with one additional longer strap.

## Precautions, Care, and Disposal Information

### Precautions:

- ⚠ CAUTION:** When putting on the Belt Pouch, ensure the pump is resting on a flat surface, and will not fall (see Figure i).  
**If the pump is not completely secure, it may fall and injure you or damage the pump.**

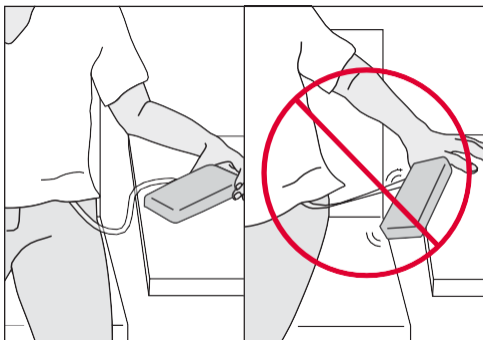

Figure i

- ⚠ CAUTION:** In the event the pump is damaged following a drop, contact your healthcare provider.
- ⚠ CAUTION:** Keep out of the reach of children when not in use to prevent the risk of strangulation.

### Caring for your AbbVie Belt Pouch:

Materials: 95% polyester, 5% spandex

Pouch Gusset: 80% nylon, 20% spandex

Care: Machine wash separately in cold water, hand wash, or dry clean. Lay flat to dry.

### Disposing of your AbbVie Belt Pouch:

Dispose of the device according to your local governing ordinances and recycling plans or contact AbbVie for help with disposal. Each device is for single-patient use only and cannot be re-sold or used on multiple patients.

## To use your AbbVie Belt Pouch

### Get familiar with your AbbVie Belt Pouch:

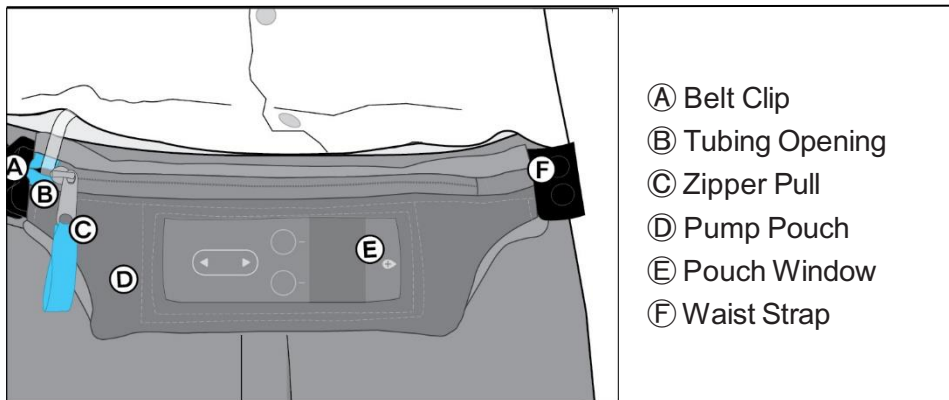

|                                                       |   |
|-------------------------------------------------------|---|
| Try on your AbbVie Belt Pouch to adjust the fit ..... | 2 |
| Put the pump in your AbbVie Belt Pouch.....           | 3 |
| Put on your AbbVie Belt Pouch.....                    | 4 |
| Interact with the pump (when needed) .....            | 4 |
| To take off your AbbVie Belt Pouch                    | 5 |
| Switch out the Waist Strap to a different size .....  | 5 |

## Try on your AbbVie Belt Pouch to adjust the fit

- 1) Place the Belt Pouch at the waistband of your pants and guide the Waist Strap under your pump tubing (see Figure A).
  - Make sure the zipper is on top of the Belt Pouch and the Pouch Window is facing out.

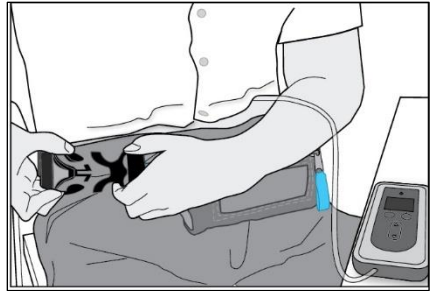

Figure A

- 2) Fasten the Belt Clip (see Figure B). Listen for a snap sound.
- 3) Move the plastic slider along the Waist Strap to adjust the Waist Strap length (see Figure C below).

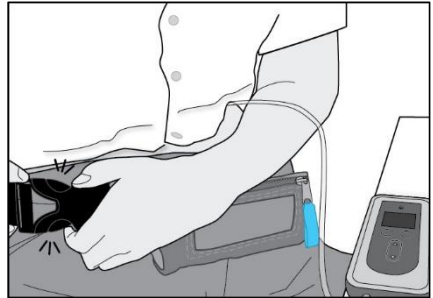

Figure B

Note: if the attached Waist Strap is too large or small, see “Switch out the Waist Strap to a different size” section on page 5.

- 4) Remove the Belt Pouch by squeezing the Belt Clip at the top and bottom until it releases.

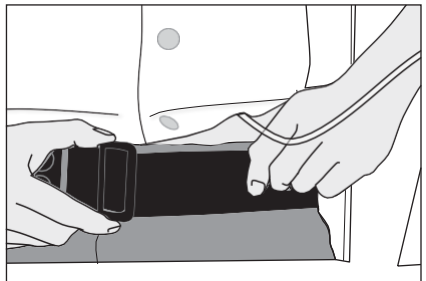

Figure C

## Put the pump in your AbbVie Belt Pouch

- 1) Place the Belt Pouch on a flat surface with the zipper facing you and the Pouch Window facing up.
- 2) Using the Zipper Pull, open the Pump Pouch completely.

- 3) Place the pump on the flat surface next to the zipper opening so that the tubing end of the pump is on the Tubing Opening side of the Pump Pouch. The display and buttons must be facing up (see Figure D).

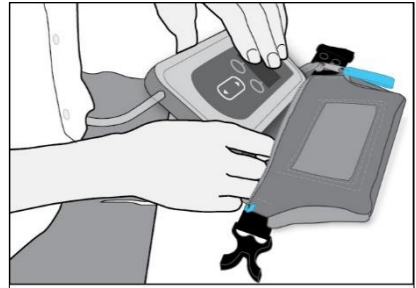

Figure D

- 4) Keep the tubing from catching on the zipper opening as you slide the pump into the Pump Pouch (see Figure E).

- 5) Route the tubing from the pump up through the Tubing Opening (see Figure E).

- Make sure there is no extra tubing inside the pouch.
- Tubing must not twist or bend.

- 6) Zip the Pump Pouch shut. While zipping, ensure the tubing does not become pinched.

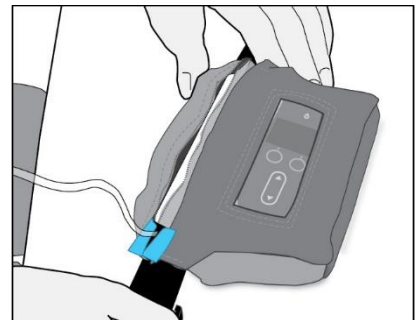

Figure E

## Put on your AbbVie Belt Pouch

1) Position the Belt Pouch under your pump tubing (see Figure F).

- Confirm the zipper is on top of the Belt Pouch and the Pouch Window is facing out.
- Make sure the Waist Strap is under your pump tubing.



Figure F

2) Fasten the Belt Clip (see Figure G). Listen for a snap sound.

- Confirm the Belt Clip is securely fastened.
- Make sure the tubing is not twisted, kinked, or pinched.

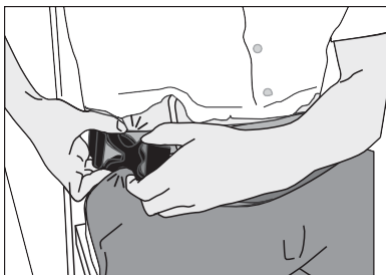

Figure G

## Interact with the pump (when needed)

1) You can interact with the pump's buttons and display through the Pouch Window (see Figure H).

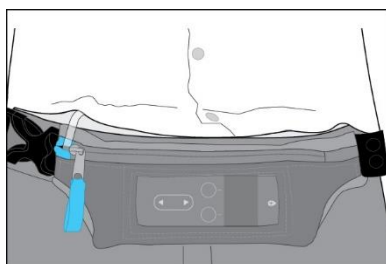

Figure H

## To take off your AbbVie Belt Pouch

- 1) Undo the Belt Clip.
- 2) Remove the Belt Pouch from your waist and place it on a flat surface.
- 3) Pull the Zipper Pull to open the Pump Pouch completely.
- 4) Remove the pump from the Pump Pouch.
- 5) Place the pump on a flat surface.

**⚠ CAUTION:** Make sure that the pump is stable on a flat surface and will not fall while you take off the Belt Pouch.

## Switch out the Waist Strap to a different size

- 1) Unclip the Belt Clip (A) and unsnap the two snaps (B) on the current Waist Strap (see Figure I).

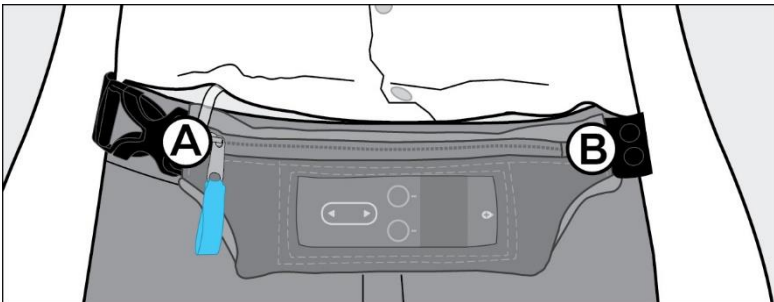

Figure I

- 2) Slide the new Waist Strap into place and snap both snaps.

## Explanation of Symbols (per ISO 15223-1):



Batch code



Catalogue Number



Caution



rxabbvie.com

Consult *instructions for use* or consult *electronic instructions for use*



Manufacturer



Medical Device



MR Safe



Single patient multiple use



Unique device identifier



Units per package



Use-by date





0AV250-004-001



Manufactured for:  
AbbVie Inc.  
1 North Waukegan Road  
North Chicago, IL 60064 USA



[rxabbvie.com](http://rxabbvie.com)

[rxabbvie.com](http://rxabbvie.com)

©2022 AbbVie. All rights reserved.

0000069

September, 2022